

OUR ROOMS/

A great range of facilities

Offerings guests a wide range of meeting spaces, however large or small your professional entourage may be, we have it covered with dedicated meeting rooms, professional networking areas and exhibition spaces, Culham is the perfect setting for like-minded professionals to get together and be... professional. Don't take our word for it though, come and take a look for yourself, we will show you around, and if you like what you see we can talk about your booking with us.

Due to our prestigious location within the Culham Science Centre, we offer impressive levels of security - making us ideal if privacy and security is required.

For meetings

Our meeting rooms, TOSCA, CLEO, DITE, ZETA, PHOENIX and COMPASS can cater for 2-70 delegates and all feature:

- Air conditioning
- HD projector and retractable screen
- Dry wipe board
- Flipchart and pens
- Free WiFi or port networking
- Complementary trainer stationery

For larger events

Our first class facility, the John Adams Lecture Theatre, seats up to 234 delegates in a tiered theatre style and is ideal for prestigious, large scale events and presentations.

As well as it's superb acoustics, the John Adams Lecture Theatre features:

- Integrated audio and visual system
- Lapel and roaming microphones
- Cinema screen projection
- Stage lighting
- Air conditioning
- Free WiFi and port networking Technical support



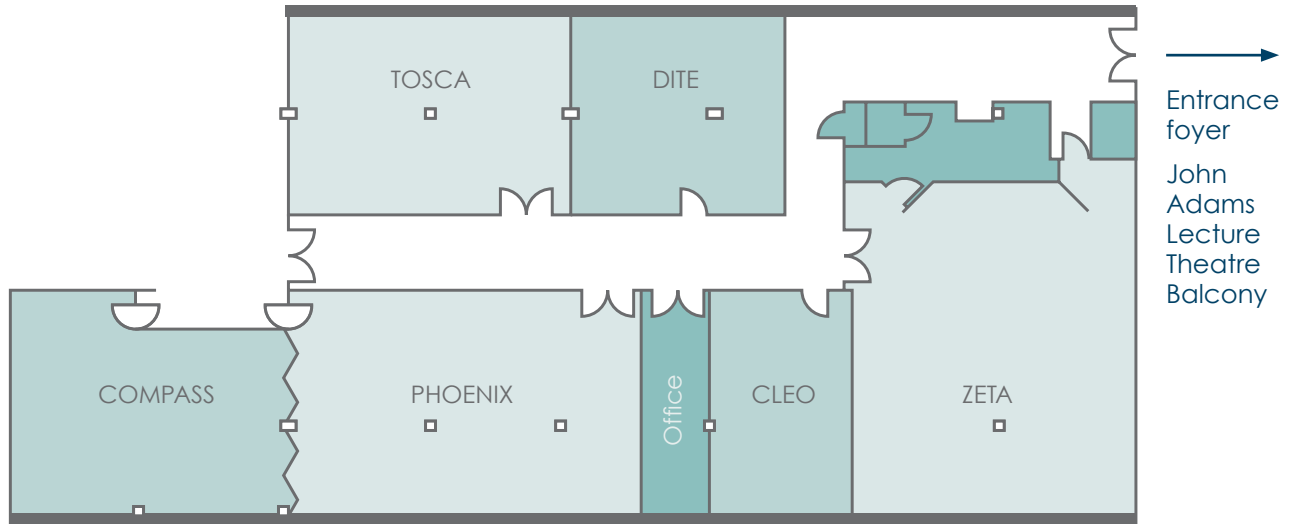

LAYOUTS/

Floor plans and room information

Our meeting rooms have been individually named after experiments carried out on this famous site.

Individual room sizes and capacities

	John Adams	TOSCA	DITE	COMPASS	PHOENIX	CLEO	ZETA
Size in metres (length x width)	19.7 x 17.1	19.7 x 3.1	7.1 x 3.1	8.5 x 5.1	11.6 x 6.3	6.3 x 4.7	8.5 x 9.1

Maximum number of delegates accommodated

	John Adams	TOSCA	DITE	COMPASS	PHOENIX	CLEO	ZETA
Theatre style	233	24	18	24	60	16	70
U-shape	-	12	-	12	18	-	24
Boardroom	-	12	10	14	22	12	24
Classroom	-	16	14	12	20	10	32

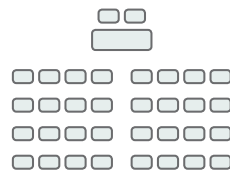

Theatre style

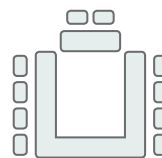

U-shape

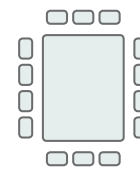

Boardroom

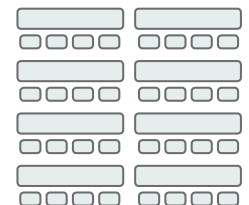

Classroom

ROOM RATES AND EQUIPMENT/

Room Hire

Meeting rooms are available to hire by the hour at the rate of **£50.00**. Alternatively, full and half day rates are listed below.

	Full day	Half day
DITE	£205.00	£100.00
CLEO	£180.00	£95.00
TOSCA	£220.00	£115.00
ZETA	£345.00	£175.00
PHOENIX	£290.00	£150.00
COMPASS	£185.00	£100.00
PHOENIX and COMPASS	£400.00	£210.00
John Adams Lecture Theatre	£600.00	£325.00
Balcony	£125.00	£100.00

Room Equipment

The John Adams Lecture Theatre and all meeting rooms are provided with the following standard equipment:

- HD ready ceiling mounted projector
- Retractable screen
- Free WiFi
- Flipchart and pens
- Dry wipe board and pens
- TV, video and DVD
- available upon request
- Complimentary trainer stationary

Equipment Hire

Additional equipment can be hired at the following costs:

- LCD projector and screen £55.00
- LCD lead £12.00
- Laptop £30.00
- Flipchart £12.00
- Fax £0.60
- Photocopying (per copy)
 - A4 sheet mono £0.12
 - A4 sheet colour £0.15

All prices quoted are exclusive of VAT